

# THE STORY OF DR. JANE GOODALL AND THE CHIMP EDEN

27th October - 26th November, 2017

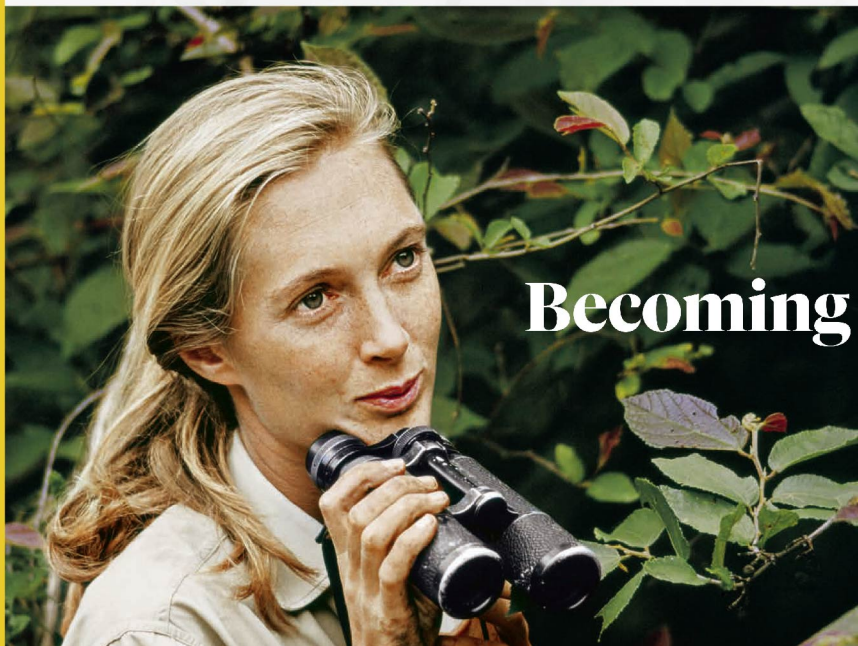

## Becoming Jane

She was a novice scientist who became famous because of her groundbreaking studies of chimpanzees. Newly revealed images shed light on how she did it, the compromises she made, and the photographer she loved.

The early discoveries that drew National Geographic's attention occurred with no cameras present. Jane Goodall disliked being photographed but would come to accept it as a way to gain support for her work.

GETTY IMAGES

*"Now we must redefine man, redefine tools, or accept chimpanzees as humans."*

- Dr. Jane Goodall



the Jane Goodall Institute  
Hong Kong

Date : 27th Oct. – 26th Nov., 2017

Opening Hours : 10:00am - 06:30pm

Venue : Wheelock Gallery, 2/F, Queensway Plaza, 93 Queensway

IN ASSOCIATION WITH

 NATIONAL  
GEOGRAPHIC  
國家地理

VENUE SPONSORED BY

WHEELOCK  
GALLERY

SUPPORTED BY

WHEELOCK  
PROPERTIES  
會德豐地產



## THE STORY OF DR. JANE GOODALL AND THE CHIMP EDEN

Discover the untold stories of the legendary naturalist and conservationist, Dr. Jane Goodall, and her dedicated work on chimpanzees protection! The exhibition will showcase some undisclosed pictures and stories of Dr. Jane in National Geographic. What's more? Take a walk at Chimp Eden and meet the lovely Chimps!

### Plan your "Adventure Route"!



#### Special Activities Natural in the City

Date & Time : 29th Oct. 10am – 12noon

Fee : \$60/ head

Explore Hong Kong Park with our tour guide and discover the hidden natural attractions of our community!

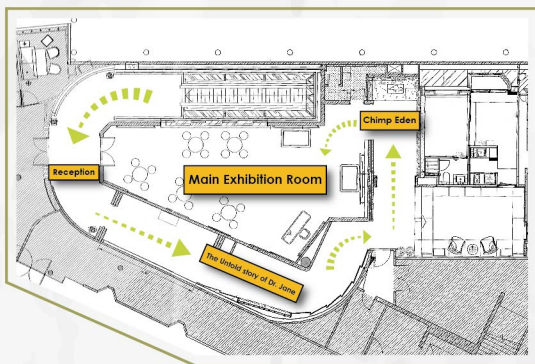

#### National Geographic Young Explorer Sharing : My Story with Jane

Date & Time : 30th Oct. 4pm– 5pm

Fee : Free of Charge

National Geographic Young Explorer Laurel Chor will share her story with Dr. Jane and how Dr. Jane inspires youngsters to chase their dreams.

#### Trees in the City

Date & Time : 12th Nov. 10am – 12noon

Fee : \$60/head

Take a walk in Wan Chai with our tour guide, learn about the trees and the stories of this hustle and bustle city.

#### Support us and save the Chimps!

Big or small, we can make a difference.  
For donation and volunteer registration:  
[www.janegoodall.org.hk](http://www.janegoodall.org.hk)



Follow Our  
Facebook



the Jane Goodall Institute  
Hong Kong

The Jane Goodall Institute (Hong Kong)  
[info@janegoodall.org.hk](mailto:info@janegoodall.org.hk)  
[www.janegoodall.org.hk](http://www.janegoodall.org.hk)